

Technical features

Design	BS5153, Rubber Sealed
Face to face	EN 558-1 Series 10 BS 5153
Flange Dimension	DIN Flanges acc. to EN 1092-2/B (DIN 2501)
Options	Lift limiter, metal seated, by-pass
Flange Options	Special flange drilling acc. to ANSI or JIS

- Ductile Iron Dikkan swing check valves, with rubber seal, full bore are suitable for horizontal and vertical installation.
- Application: Cold and hot water, fresh water, tse and drainage, sewage.

Pressure & temperature ranges

Bore	Pressure rating	Hydro test pressure [bar]	
		Casing	Closure
DN 32 - DN 600	PN16	24	17.6

Material specifications

Part No.	Component	Material		
1	Body	EN-GJS400-18-LT	EN-JS 1025	GGG40.3
2	Bonnet	EN-GJS400-18-LT	EN-JS 1025	GGG40.3
3	Body seat	CuSn5Zn5Pb5-C	CC491K	RG5
4	Stem	AISI316	AISI316	AISI316
5	Disc,	AISI316	AISI316	AISI316
6	Hinge arm	EN-GJS400-18-LT	EN-JS 1025	GGG40.3
7	Disc sealing	CuSn5Zn5Pb5-C	CC491K	RG5
8	Bonnet gasket	Asbestos-free	Asbestos-free	Asbestos-free
9	Bolts, nuts	AISI316	AISI316	AISI316

Dimensions & ordering codes

DN [mm]	Flange Connection	ØD [mm]	L [mm]	H [mm]	C [mm]	Weight [kg]	Dikkan ordering code
32	PN16	140	140	95	200	7	B034L3566XPPP18400320000
40	PN16	150	165	95	200	9	B034L3566XPPP18400400000
50	PN16	165	203	100	200	11	B034L3566XPPP18400500000
65	PN16	185	216	115	300	16	B034L3566XPPP18400650000
80	PN16	200	241	135	300	24	B034L3566XPPP18400800000
100	PN16	220	292	145	300	29	B034L3566XPPP18401000000
125	PN16	250	330	160	400	41	B034L3566XPPP18401250000
150	PN16	285	356	185	400	60	B034L3566XPPP18401500000
200	PN16	340	495	270	500	120	B034L3566XPPP18402000000
250	PN16	395	622	320	500	172	B034L3566XPPP18302500000
300	PN16	445	698	350	500	280	B034L3566XPPP18303000000
350	PN16	505	787	435	670	380	B034L3566XPPP18303500000
400	PN16	565	914	475	900	590	B034L3566XPPP18304000000
500	PN16	670	978	570	1100	990	B034L3566XPPP18305000000
600	PN16	780	1295	670	1100	1200	B034L3566XPPP18306000000



Ductile Iron
Bronze Trim
Lever & Counter Weight
Dikkan figure 34LC.3566

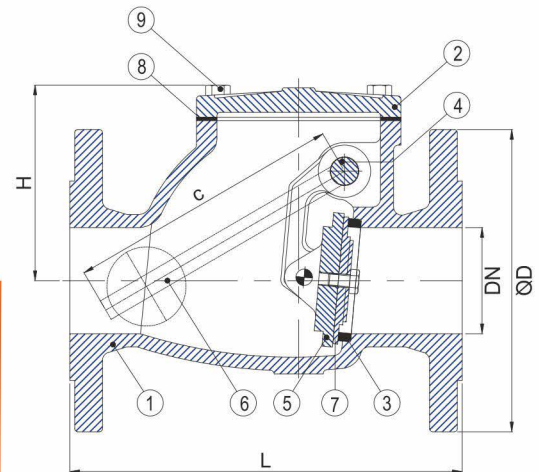

**SWING CHECK VALVE
USER MANUAL****INSTALLATION AND OPERATION
INSTRUCTIONS OF THE SWING CHECK VALVE****MANUFACTURER**

Name : DIKKAN BORU VE TES. MALZ. SAN. VE TIC A.Ş.
Address : Kemalpaşa Hayıtlıkır Mevkii,
Kemalpaşa-İZMİR/ TURKEY
Phone : (+90 232) 877 17 14
Fax : (+90 232) 877 17 15

PRODUCT INFORMATION

Valve Name : SWING CHECK VALVE (Dikkan figure34)
Trademark : DIKKAN
Nominal Diameter (DN) : DN15-DN150 / DN200-DN600
Material : GG25, GGG40.3, GSC25
Nominal Pressure (PN) : 16 bar /10 bar
Working Temperature : -10°C ...+120°C

SELLER

Name : DIKKAN DIS TICARET A.S.
Address : İZMİR-KEMALPASA YOLU HAYITLIKIR MEVKI
ULUCAK KOYU KEMALPASA İZMİR - TURKEY
Phone : +90 232 877 17 14
Fax : +90 232 877 17 15

APPLICATION AREAS

- Cold and hot water systems
- Drinking water and irrigation systems
- Fire fighting systems
- Pumping stations
- Storage tanks
- Pipe lines
- TSE and Drainage
- Sewage

Doc. No: FRM.60 Rev. No:02 Rev. Date: 22.12.2010

*Before mounting the valve, the pipe line should be cleaned with pressure air or steam in order to eliminate the potential burrs, corrosions, foreign substances and dirt which may exist within the line.

* Both the axes of the pipes where they will be mounted and the hole axes of the connection element to be used should be in the same axis.

* In flanged connections, bolts suitable for flange holes should be used.

* If the connection element is flange, its bolts will be released by tightening them mutually, then the bolts will be tightened back in torque values given mutually.

* If the space for valve is left during installation, both the length of the valve and the length of the leakage elements to be used should be calculated before leaving such space.

* If the type of the connection will be threaded, the length of the thread on the pipe should not be less than the length of the valve thread.

*For the valve to be newly mounted, the labels / covers on both flanges should be removed.

* The valve to be mounted on the installation should be mounted considering the flange side, where the technical specifications are indicated, will be the inlet part. Afterwards, the other side will be mounted on the installation so as to eliminate the possibility of pulling tension.

*While connecting the check valve to the installation, please ensure that the direction arrow should be in flow direction.

*For detail information, please look at the DIKKAN catalogue of product or get in touch with our company.

